

**HEALTH AND SAFETY INFORMATION**

SIGNIFICANT OR EXCEPTIONAL RISKS ARE IDENTIFIED BELOW

CONSTRUCTION PHASE

- PLEASE REFER TO THE DESIGN RISK MANAGEMENT SCHEDULE AND THE WORKS INFORMATION FOR DETAILS OF THE RISKS ASSOCIATED WITH THIS WORK. SZC-AD0252-WSP-ADHGEN-000000-REG-HCH-000001
- RESIDUAL HAZARDS / RISKS ARE LISTED HERE AND REFERENCED ON THE DRAWING.
- THE CONTRACTOR SHALL REFER TO STATUTORY UNDERTAKERS LAYOUT DRAWINGS AND IDENTIFY LOCATIONS OF EXISTING UNDERGROUND SERVICE PRIOR TO CARRYING OUT EXCAVATION WORKS.

**KEY TO HEALTH AND SAFETY SYMBOLS**

	INDICATES A RESIDUAL RISK REQUIRING A COMPULSORY ACTION.
	INDICATES A RESIDUAL RISK FOR INFORMATION.
	INDICATES A RESIDUAL RISK REQUIRING A PROHIBITIVE ACTION.
	INDICATES A RESIDUAL RISK AS A WARNING.

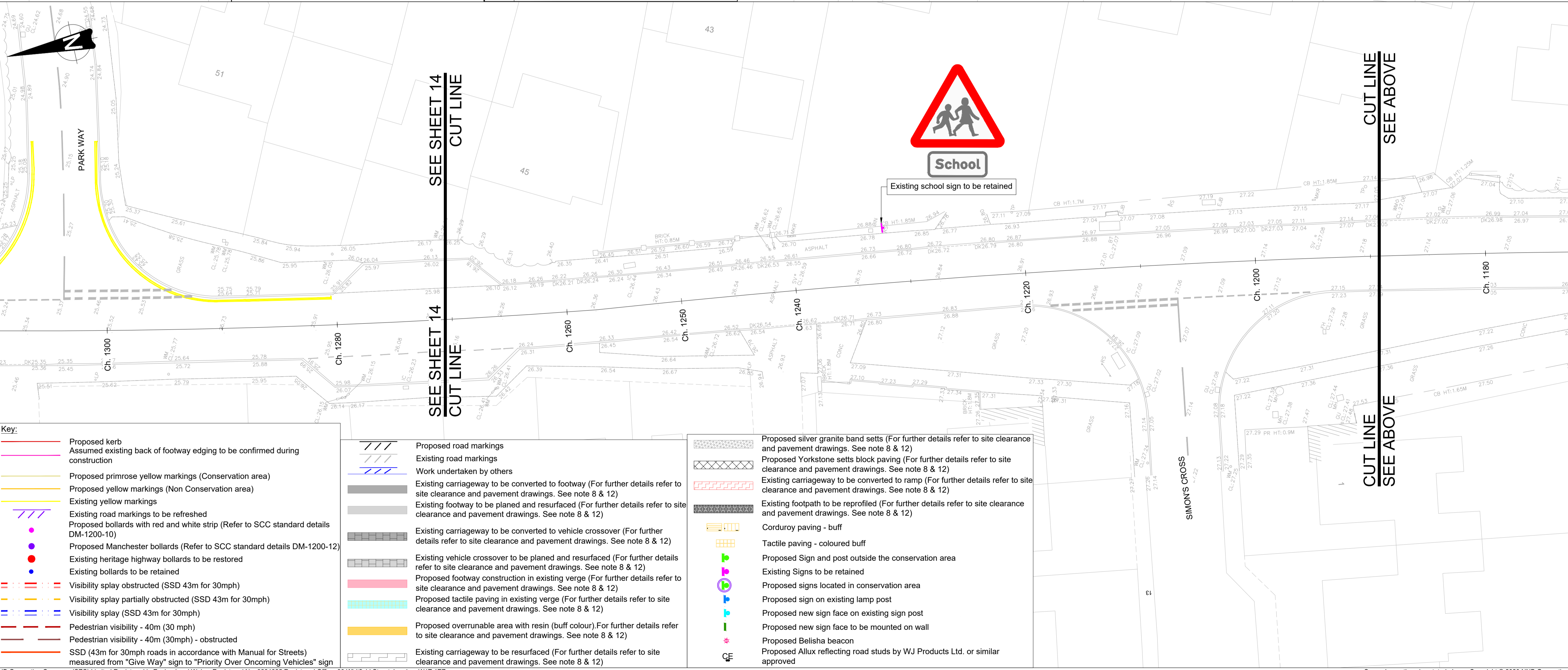

**Key:**

	Proposed kerb
	Assumed existing back of footway edging to be confirmed during construction
	Proposed primrose yellow markings (Conservation area)
	Proposed yellow markings (Non Conservation area)
	Existing yellow markings
	Existing road markings to be refreshed
	Proposed bollards with red and white strip (Refer to SCC standard details DM-1200-10)
	Proposed Manchester bollards (Refer to SCC standard details DM-1200-12)
	Existing heritage highway bollards to be restored
	Existing bollards to be retained
	Visibility splay obstructed (SSD 43m for 30mph)
	Visibility splay partially obstructed (SSD 43m for 30mph)
	Visibility splay (SSD 43m for 30mph)
	Pedestrian visibility - 40m (30 mph)
	Pedestrian visibility - 40m (30mph) - obstructed
	SSD (43m for 30mph roads in accordance with Manual for Streets) measured from "Give Way" sign to "Priority Over Oncoming Vehicles" sign

	Proposed road markings
	Existing road markings
	Work undertaken by others
	Existing carriageway to be converted to footway (For further details refer to site clearance and pavement drawings. See note 8 & 12)
	Existing footway to be planed and resurfaced (For further details refer to site clearance and pavement drawings. See note 8 & 12)
	Existing carriageway to be converted to vehicle crossover (For further details refer to site clearance and pavement drawings. See note 8 & 12)
	Existing vehicle crossover to be planed and resurfaced (For further details refer to site clearance and pavement drawings. See note 8 & 12)
	Proposed footway construction in existing verge (For further details refer to site clearance and pavement drawings. See note 8 & 12)
	Proposed tactile paving in existing verge (For further details refer to site clearance and pavement drawings. See note 8 & 12)
	Proposed overrun area with resin (buff colour) For further details refer to site clearance and pavement drawings. See note 8 & 12)
	Existing carriageway to be resurfaced (For further details refer to site clearance and pavement drawings. See note 8 & 12)

	Proposed silver granite band sets (For further details refer to site clearance and pavement drawings. See note 8 & 12)
	Proposed Yorkstone sets block paving (For further details refer to site clearance and pavement drawings. See note 8 & 12)
	Existing carriageway to be converted to ramp (For further details refer to site clearance and pavement drawings. See note 8 & 12)
	Existing footpath to be reprofiled (For further details refer to site clearance and pavement drawings. See note 8 & 12)
	Corduroy paving - buff
	Tactile paving - coloured buff
	Proposed Sign and post outside the conservation area
	Existing Signs to be retained
	Proposed signs located in conservation area
	Proposed sign on existing lamp post
	Proposed new sign face on existing sign post
	Proposed new sign face to be mounted on wall
	Proposed Belisha beacon
	Proposed Allux reflecting road studs by WJ Products Ltd. or similar approved

**UK PROTECTIVE MARKING:**  
NOT PROTECTIVELY MARKED

Reproduced from Ordnance Survey map with the permission of Ordnance Survey on behalf of the controller of Her Majesty's Stationery Office © Crown copyright (2023). All Rights reserved. NNB GenCo Licence: 0100060408

**DRAWING GRID / COORDINATE SYSTEM:**

SITE LOCAL GRID  NATIONAL GRID OSGB36

OTHER GRID  (To be defined in the contract project plan)

CONTRACT PROJECT PLAN DOC. REF. No: N/A

- All dimensions are in metres unless otherwise stated.
- All levels are in metres above ordnance datum.
- All drawings to be read in conjunction with all relevant Architects and Engineers drawings and details.
- All signs and road markings are to be in accordance with the Traffic Signs Regulations and General Directions 2016.
- Certain extents of the site layout are based on topographical survey completed by Warner Surveys for Wickham Market LT/220/0519/P/0001 - 19, LT/220/0556/P0001-7 in November 2020 and LT220057P202A-G in March 2023. WSP takes no responsibility for the accuracy of the survey data.
- Lines and levels of existing buried utilities are yet to be established and the layouts may need to be revised as part of mitigation measure to minimize any impact on existing utilities.
- For kerb upstand details, refer to Cross Section drawings: SZC-AD0252-WSP-ADHGN-54XXXX-DRW-HCH-000041 to SZC-AD0252-WSP-ADHGN-54XXXX-DRW-HCH-000048.
- For Pavement and kerbing details, refer to SZC-AD0252-WSP-ADHGN-54XXXX-DRW-HCH-000001-000018
- Existing verge to be made good following construction. Proposed reinstatement verge seed mix. Refer to series 3000 Appendix 30/5 for specification details.
- All tree and vegetation-related works should comply with the arboriculturalists' report.
- Existing utilities affected by the work must be protected or modified in accordance with the requirements and approval of the relevant statutory undertakers. The actual type, location and status of all utility apparatus must be determined and confirmed on site by the contractor using the procedure detailed in HSEHS47 and BSI PAS 128:2022. For example, existing apparatus to be surveyed using GPR, EML, CAT scan or trial holes, as appropriate.
- For planting details refer to site clearance drawings SZC-AD0252-WSP-ADHSC-54XXXX-DRW-HCH-000001-000018.
- All construction works, vegetation clearance and vegetation management should be completed with an EcoW present, and in line with the Ecological Method Statement (SZC-AD0252-WSP-ADHLS-54XXXX-MST-HCH-000001) and Landscape and Ecological Management Plan (SZC-AD0252-WSP-ADHLS-54XXXX-REP-HCH-000001), which should be referred to at each stage of the construction process.

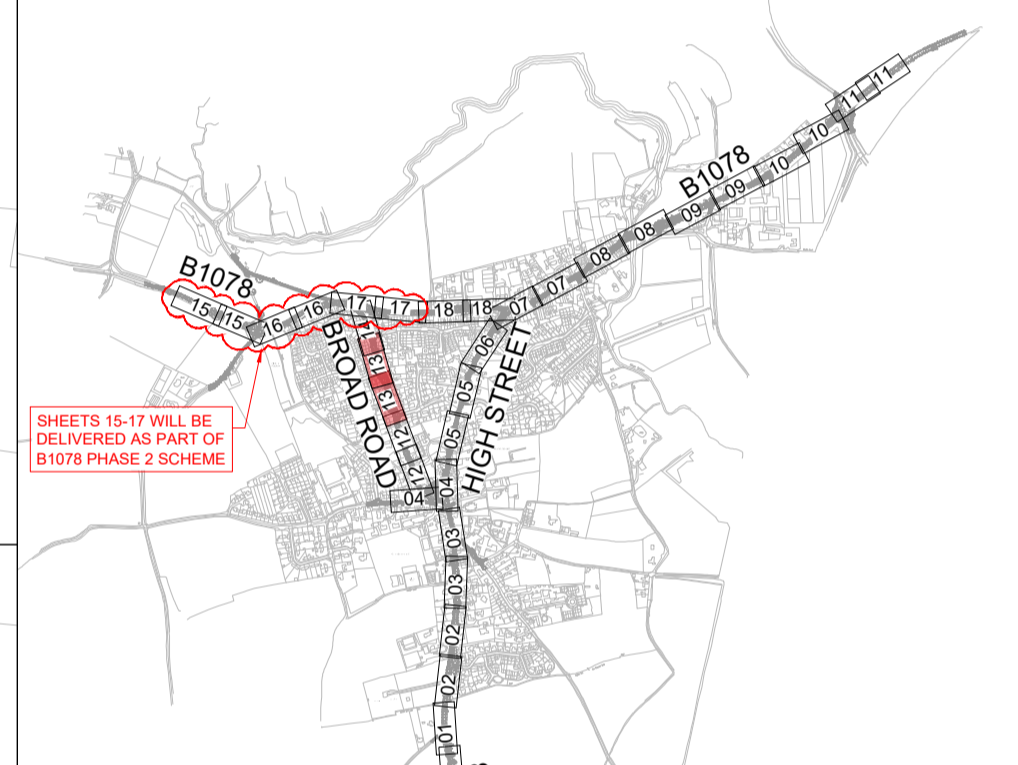

**LOCATION PLAN SCALE 1:20000**

REV.	DATE	PREPARED BY	CHECKED BY	STATUS	REASONS FOR REVISION	APPROVED BY
P07	23/01/26	NM	PB	P1	SZC COMMENTS INCORPORATED	MB
P06	27/11/24	NM	PB	P1	SZC COMMENTS INCORPORATED	MB
P05	10/09/24	NM	PB	S2	SZC, RSA COMMENTS INCORPORATED	MB
P04	29/05/24	NM	PB	S2	FOR INFORMATION	MB
P03	05/01/24	SB	PB	S6	SZC, RSA COMMENTS INCORPORATED	PB
P02	27/10/23	SB	PB	S3	COMMENTS INCORPORATED	PB
P01	07/09/23	NM	PB	S3	FIRST REVISION	PB

**CONTRACTOR COMPANY TRADE NAME : WSP**

1st partner	2nd partner
NNB GEN	EDF ENERGY

CONTRACTOR REF. No. SZC-AD0252-WSP-ADHGN-54XXXX-DRW-HCH-000013

CONTRACT NUMBER : WSP\_ASD000-007

CONTRACTOR WBS CODE: AD0252

QRA RELATED Yes  No

APPLICABILITY:

1: Document related to Unit 1  
2: Document related to Unit 2  
9: Document that applies to buildings/systems common to Unit 1 & 2  
0: Documents that relate exclusively to buildings or systems that are common to the whole site (e.g. parking, ancillary buildings...)

NUCL/REP/EPR/UX	BUILDING
SZC ( doc: SZ )	000
0 1 2 9	SYSTEM
X	N/A

SCALE 1:200

DESCRIPTION PROPOSED GENERAL ARRANGEMENT (BROAD ROAD) WICKHAM MARKET SCHEME SHEET 13

TEAMCENTER DOCUMENT REFERENCE No. 101539661

DOCUMENT SUB -TYPE DRW	EDF CLASSIFICATION CODE N/A
SUBCONTRACTOR COMPANY TRADE NAME N/A	SUBCONTRACTOR DOCUMENT REF. No N/A

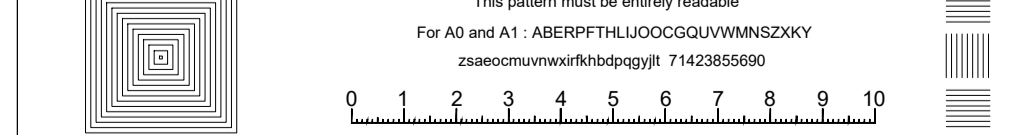

INTELLECTUAL PROPERTY OWNERSHIP: NNB: OWNERSHIP	EDF: N/A	CONTRACTOR: OWNERSHIP
---	----------	-----------------------

**UK PROTECTIVE MARKING:**  
NOT PROTECTIVELY MARKED